

中原大學

Chung Yuan Christian University



2027/2028 Exchange Student Program

CHUNG YUAN CHRISTIAN UNIVERSITY

TAOYUAN, TAIWAN

Welcome to Chung Yuan Christian University (CYCU)! This guide provides everything you need to know about joining our exchange program — from application deadlines and housing to language requirements and campus life in Taiwan.

Office of International and Cross-Strait Education

Contact Person: Ms. I-Wen Chen

Address: No. 200, Zhongbei Rd., Zhongli Dist., Taoyuan City 320314, Taiwan (R.O.C.)

Email: incoming_exchange@cycu.edu.tw

Tel: +886-3-265-1725

Useful Links

→ [CYCU Official Website](#)

→ [Exchange Student Program](#)

2027/28 Application Schedule & Key Deadlines

Plan ahead – nominations and applications must be submitted well before the semester begins. Below is the full timeline for both intake periods.



Nomination Deadline for Spring 2027

31 October 2026

Application Deadline for Spring 2027

15 November 2026

Sent Admission Letter and Pre-Departure Notice

Before 15 December 2026

Spring 2027 Semester

Admission Duration: 22 February 2027 – 25 June 2027



Nomination Deadline for Fall 2027

30 April 2027

Application Deadline for Fall 2027

15 May 2027

Sent Admission Letter and Pre-Departure Notice

Before 15 June 2027

Fall 2027 Semester

Admission Duration: Mid-September 2027 – Mid-January 2028

 Class registration takes place during the **first week of the back-to-school day**. Airport pick-up service is available two days before the back-to-school day, from **10:00 to 19:00**. Arrivals outside this window cannot be guaranteed a pick-up.



Admission Requirements

1. Language Proficiency

Applicants must demonstrate English or Chinese language proficiency with one of the following minimum scores:

TOEFL iBT

64

IELTS

5.0

TOEIC

700

HSK

Level 4

Alternatively, proof of proficiency at **CEFR B1 level or above** is acceptable. Applicants from English-speaking countries are exempt from submitting an official English test score.

2. Academic Requirement

A minimum GPA of **2.5 on a 4.0 scale** is required for all applicants.

3. Credit Requirements

- **Undergraduate:** 6 credits min. to 25 credits max.
- **Graduate / Ph.D.:** 3 credits min. to 25 credits max.

- ❑ Exchange students are **not eligible** to enroll in **in-service master's programs** or **Dual Degree Programs**. Course enrollment is subject to instructor approval after the semester begins.



Re-Cheng Dormitory

All exchange students are housed in the **Re-Cheng Dormitory** – a comfortable on-campus residence with essential amenities included.

Room & Fees

Cost: NT\$ 16,500 / person / semester
(4 people per room, meals not included)

Internet: Included

Kitchen: Included – food heating machines available
(cooking not permitted)

Bedding: Students must purchase their own mattress and blanket.

Room Facilities

- Desk, bed, air conditioner
- Bookshelf, wardrobe, phone
- Shoes cabinet, desk lamp

Shared Facilities

- Conference room, study room
- Drinking fountain, water dispenser
- Printer, recreation area

⚠ There are **no public PCs** in the dormitory. Students must bring their own laptop. Mattress pads, blankets, pillows, toiletries, and laundry powder can be purchased locally for approximately **NT\$10,000**.

[Re-Cheng Dormitory Short Video Introduction](#)

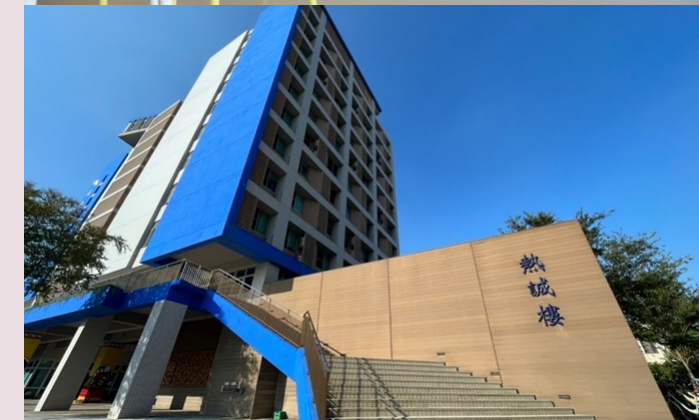

Costs & Living Expenses

NT\$ 0

Tuition

Tuition is fully waived for all exchange students.

NT\$ 500

Daily Living

Average daily living expense estimate.

NT\$ 120

Cafeteria Meal

Regular meal cost ranges from NT\$120 to NT\$200.

NT\$ 16,500

Dorm / Semester

Re-Cheng Dorm, per person, per semester (excl. meals).

NT\$ 10,000

Initial Setup

Estimated cost for bedding, toiletries, and essentials upon arrival.





Programs & Activities

The OIA organizes **Cultural Trips and other activities** exclusively for international students throughout the semester — a great way to explore Taiwan and connect with fellow exchange students.



Course Search

Browse available classes for exchange students at:



Chinese Language Learning

CYCU offers multiple pathways for exchange students to learn.

Free Mandarin Courses



Free Mandarin language courses are offered to all exchange students at no additional cost. These credit-bearing courses cover **reading, listening, speaking, and writing** skills, providing comprehensive language training to support both academic success and daily life in Taiwan. Each course is worth 2 academic credits, allowing students to enhance their Mandarin proficiency while earning credits during their exchange semester.



MANDARIN LEARNING CENTER, CYCU

The MLC at CYCU offers long-term Mandarin courses, one-on-one sessions, and short-term Mandarin camps. Both one-on-one and camp formats can be customized to your specific needs. Online and in-person options are available.

[Mandarin Learning Center Website](#)





Health, Insurance & Visa

Insurance

Students must purchase both **Medical and Travel Insurance** in their home country before arriving in Taiwan. CYCU does not arrange insurance on behalf of students.

Health Certificate Form

One-semester exchange students

Complete the Health Certificate for Short-Term Students, with an official seal/signature from a doctor/hospital/medical institution.

Please refer to the [Taiwan CDC Website](#)

One-academic year exchange students

One-academic-year exchange students will join local students in the university's on-campus health examination.

Visa Assistance

The OIA will assist students who hold a Visitor Visa (60 or 90 days) to **extend their visa** before the expiry date while in Taiwan.



Campus Life & Facilities

On-Campus Facilities

CYCU's campus is well-equipped with everything you need for daily life and study:

- Starbucks & McDonald's
- Post Office
- Library
- Gym & Swimming pool
- Chapel on campus
- Baptist Church & Interdenominational Church (adjacent to campus)

Around the Campus

- Restaurants & Night Market
- Bank & Supermarket
- Coffee shops & Beauty shops
- Hospital

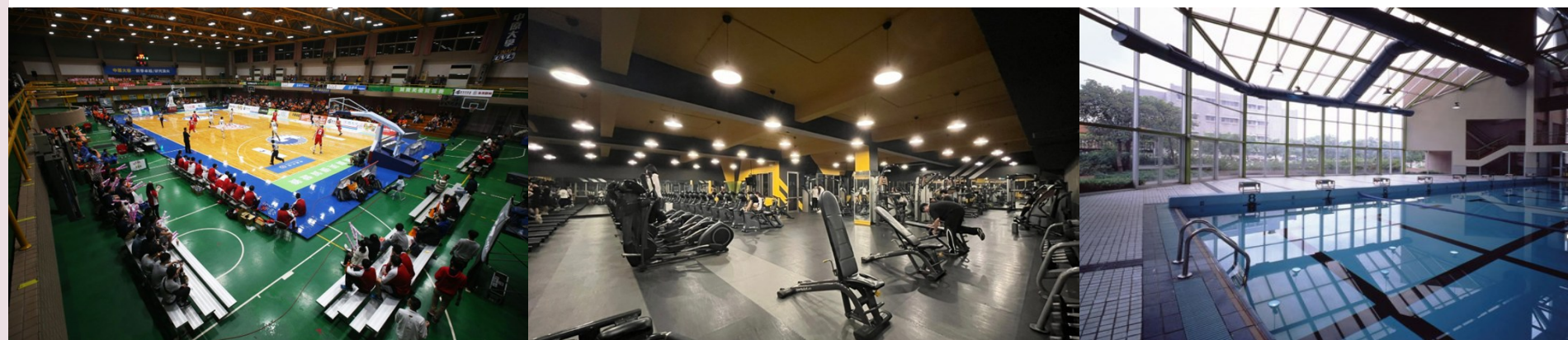

Weather & Packing Tips

Taiwan has a subtropical climate with warm, humid summers and mild winters. Here's what to expect throughout the year and how to prepare.

Spring (Mar–May)

20–25°C

Mild and pleasant. Light layers recommended. Spring semester students arrive during this period.

Summer (Jun–Aug)

27–35°C

Hot and humid. Light, breathable clothing essential. Stay hydrated!

Autumn (Sep–Nov)

20–28°C

Warm and comfortable. Fall semester students arrive during this period.

Winter (Dec–Feb)

10–22°C

Cool and occasionally cold. Note: there is **no central heating** in homes or on campus.

 **Important for Spring Semester Students:** Taiwan does not have heating at home or in school. We strongly recommend bringing **warm clothes and layers** for the cooler months of February and March.

What to Bring

- Personal laptop (no public PCs in dorm)
- Credit cards and cash. If you need to exchange currency in Taiwan, USD, EUR, JPY, KRW, and CNY are more convenient to exchange.

Buy Locally

- Mattress pad, blanket, pillow
- Toiletries, laundry powder, ect.
- Estimated cost: ~NT\$10,000